

# Dash Assemblies - All Models

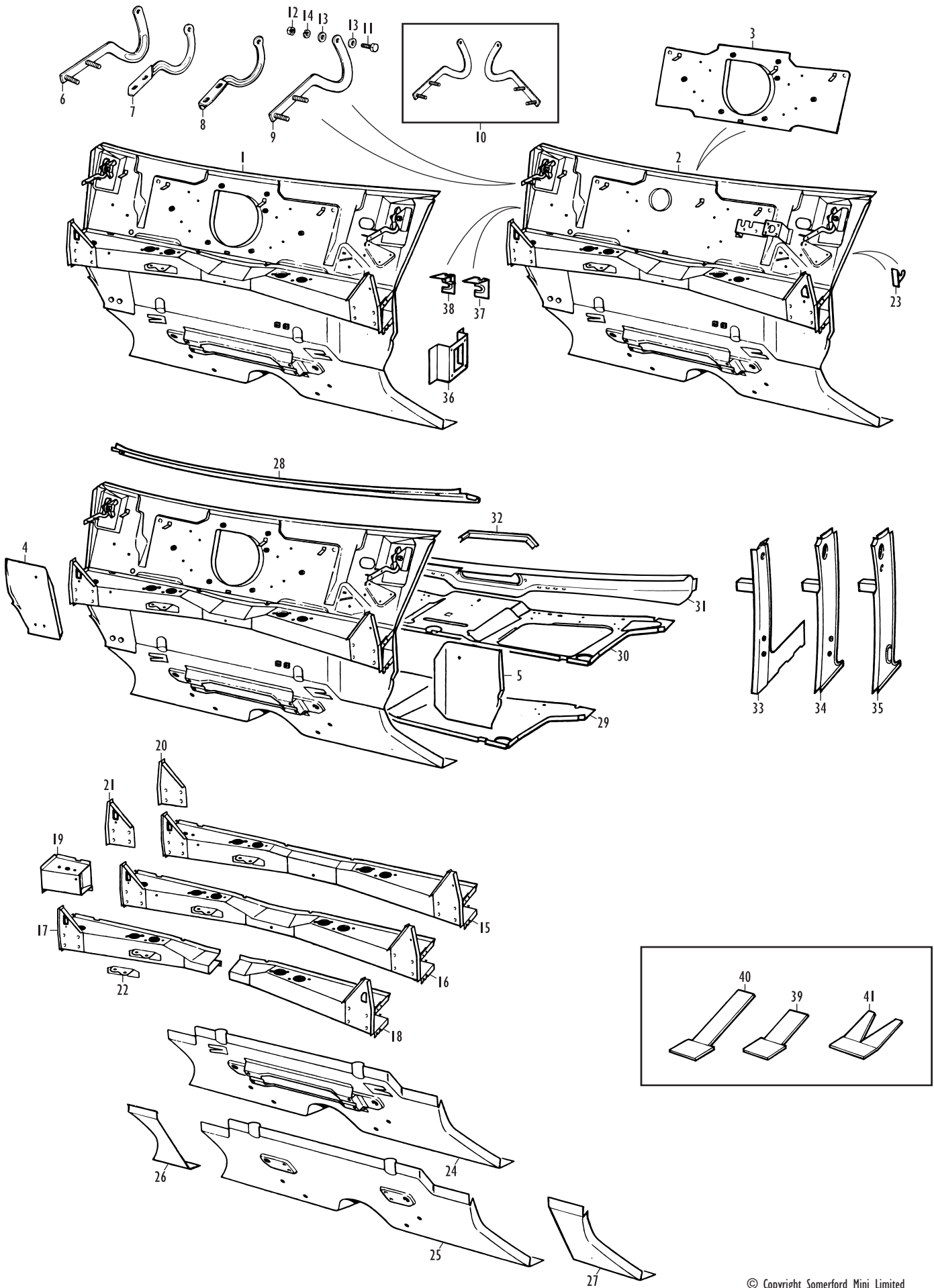

# Dash Assemblies - All Models

No.	Part No.	Description	Qty.	Remarks
<b>Dashboard Assembly</b>				
Dash complete assemblies are available for models from 1976 onwards. They include the dash panel, bonnet hinges, crossmember, toeboard, front parcel shelf and upper fascia panel. They do not include the parcel shelf moulding or A post lower closing plates. The crossmember to inner wing stiffeners (the triangular plates at each end of the dash crossmember) fitted are not suitable for Clubman models.				
1	CZH3216	DASH COMPLETE ASSEMBLY	1	1976-89; for rubber mounted subframe.
2	AHA36005	DASH COMPLETE ASSEMBLY	1	1990 on; for fuel injected (SPi and MPI) models.
3	HMP441017	CONVERSION PANEL, Rotodip piercing	1	Converts SPi or MPI dash panel to accept centre instrument binnacle.
Owners of earlier Minis may at some point have found themselves wondering why their car has a lopsided egg-shaped hole in the dash panel and a similar one in the rear seat brace, when viewed from inside the boot. These holes were, like the slinging shoe brackets under the sills, features used by the mechanical bodyshell handling equipment in the factory and served no official purpose after the car had been built (except the hole in the dash served as relatively easy access to the back of centre-mounted fascia instruments, of course, and the slinging shoe brackets were sometimes mistaken for jacking points, with disastrous consequences).				
Up until the 1980s, when a new body treatment and painting system succeeded the traditional methods, new Mini bodysells were treated against corrosion by immersion in a large tank of solution, prior to painting. During the immersion in what was called the Rotodip, the bodies were turned over in a largely successful attempt to ensure complete coverage of the steel with the solution. To enable this, each body was mounted spitroast-fashion on a long pole running lengthways through the specially shaped Rotodip holes in the dash and rear seat back. So now you know, if you didn't beforehand.				
4	REPANI174	DASH LOWER CORNER REPAIR, RH	1	Non-genuine.
5	REPANI175	DASH LOWER CORNER REPAIR, LH	1	Non-genuine.
6	14A7246	BONNET HINGE, RH	1	1959-69; inboard hinge mounting type.
	14A7247	BONNET HINGE, LH	1	1959-69; inboard hinge mounting type.
7	CZH146	BONNET HINGE, RH	1	1969-70; inboard hinge mounting type. Not Clubman.
	CZH147	BONNET HINGE, LH	1	1969-70; inboard hinge mounting type. Not Clubman.
8	CZH150	BONNET HINGE, RH	1	1969-70; inboard hinge mounting type. Clubman.
	CZH151	BONNET HINGE, LH	1	1969-70; inboard hinge mounting type. Clubman.
9	CZH530	BONNET HINGE, RH	1	1970-80; outboard hinge mounting type.
	CZH531	BONNET HINGE, LH	1	1970-80; outboard hinge mounting type.
	BMP348	BONNET HINGE, RH	1	1980 on; outboard hinge mounting type.
	BMP349	BONNET HINGE, LH	1	1980 on; outboard hinge mounting type.
10	HMP441027	BONNET HINGE KIT, pair of hinges	1	1980 on; outboard hinge mounting type. The 1970-80 type bonnet hinges can be replaced by the 1980 on type, but only if both are replaced at the same time: hence the HMP441027 kit.
11	SH604071	SCREW, hinge to dash	2	
12	NH604051	NUT, hinge to dash	2	
13	2K9026	WASHER, plain	4	
14	LWZ204	WASHER, locking	2	
15	ALA5515	DASH CROSSMEMBER COMPLETE ASSY.	1	1959-74, not Clubman. For solid mounted front subframe.
	CZH421	DASH CROSSMEMBER COMPLETE ASSY.	1	1969-74, Clubman. For solid mounted front subframe.
	CZH3184	DASH CROSSMEMBER COMPLETE ASSY.	1	1975, not Clubman. Solid mounted subframe, waxstat carburetters.
	CZH3185	DASH CROSSMEMBER COMPLETE ASSY.	1	1975, Clubman. Solid mounted subframe, waxstat carburetters.
16	CZH3355	DASH CROSSMEMBER COMPLETE ASSY.	1	1976-89, not Clubman. For rubber mounted front subframe. Includes mounting point for brake PDWA valve.
	CZH3354	DASH CROSSMEMBER COMPLETE ASSY.	1	1976 on, Clubman. For rubber mounted front subframe. Includes mounting point for brake PDWA valve.
	AHC36003	DASH CROSSMEMBER COMPLETE ASSY.	1	1990 on; will fit 1976-89 models (not Clubman), but lacks mounting for PDWA valve.
17	AHC36003R	HALF CROSSMEMBER ASSEMBLY, RH	1	1990 on; will fit 1976-89 models (not Clubman), but lacks mounting for PDWA valve.
18	AHC36003L	HALF CROSSMEMBER ASSEMBLY, LH	1	1990 on; fits 1976 on models (not Clubman).
19	REPANI176	CROSSMEMBER END REPAIR, RH	1	1959-75; non-genuine. Not Hydrolastic suspension models.

No.	Part No.	Description	Qty.	Remarks
	REPANI177	CROSSMEMBER END REPAIR, LH	1	1959-75; non-genuine. Not Hydrolastic suspension models.
	REPANI178	CROSSMEMBER END REPAIR, RH	1	1964-71; non-genuine. Hydrolastic suspension models only.
	REPANI179	CROSSMEMBER END REPAIR, LH	1	1964-71; non-genuine. Hydrolastic suspension models only.
20	REPANI180	STIFFENER, crossmember, RH	1	1959-69; non-genuine.
	REPANI181	STIFFENER, crossmember, LH	1	1959-69; non-genuine.
21	AHP36001	STIFFENER, crossmember, RH	1	1990 on; may be used on 1969-89 models, not Clubman.
	AHP36007	STIFFENER, crossmember, LH	1	1990 on; may be used on 1969-89 models, not Clubman.
	REPANI182	STIFFENER, crossmember, RH	1	1969 on, Clubman; non-genuine.
	REPANI183	STIFFENER, crossmember, LH	1	1969 on, Clubman; non-genuine.
22	14A6730	BRACKET, engine stabilizer and clutch pipe	1	
23	24A1252	BRACKET, heater attachment	2	
24	ALA6602	TOEBOARD ASSY., with rack mountings	1	1959-75; for solid mounted subframe.
	AAM1028	TOEBOARD ASSY., with rack mountings	1	1976-89; for rubber mounted subframe.
	AHA36006	TOEBOARD ASSY., with rack mountings	1	1990 on; may be used on 1976-89 models.
25	AHA36007	TOEBOARD PANEL	1	1990 on; may be used on 1976-89 models, or adapted for earlier use.
26	REPAN070R	TOEBOARD END REPAIR, RH	1	Non-genuine.
27	REPAN070L	TOEBOARD END REPAIR, LH	1	Non-genuine.
28	14A6675	FASCIA PANEL, upper ('ashtray panel')	1	Includes piercings for mounting soft trim cover; may be adapted for earlier models with painted, untrimmed upper fascia.
29	14A9965	FRONT PARCEL SHELF PANEL	1	1959-69.
30	CZH231	FRONT PARCEL SHELF PANEL	1	1970 on; produced to later condition with large cut-outs. May be used on earlier models.
	BMP122	FRONT PARCEL SHELF PANEL	1	Alternative to CZH231.
31	ALA6676	MOULDING, front parcel shelf	1	For use on models with painted, untrimmed parcel shelf moulding.
	BMP201	MOULDING, front parcel shelf	1	For use on models with soft trimmed parcel shelf moulding. Will not accept switch panel on models with painted, untrimmed moulding.
32	14A7175	RETAINER, parcel shelf carpet	1	1959-96.
33	14A6518	BOXING PLATE ASSEMBLY, lower, RH	1	1959-62; for external door hinge models.
	14A6519	BOXING PLATE ASSEMBLY, lower, LH	1	1959-62; for external door hinge models.
34	14A8372	BOXING PLATE ASSEMBLY, lower, RH	1	1962 on; for external door hinge models.
	14A8373	BOXING PLATE ASSEMBLY, lower, LH	1	1962 on; for external door hinge models.
35	ALA5686	BOXING PLATE ASSEMBLY, lower, RH	1	1969 on; for internal door hinge models.
	ALA5687	BOXING PLATE ASSEMBLY, lower, LH	1	1969 on; for internal door hinge models.
	ALA5688	BOXING PLATE, lower, RH, without shelf bracket	1	1969 on; for internal door hinge models.
	ALA5689	BOXING PLATE, lower, LH, without shelf bracket	1	1969 on; for internal door hinge models.
36	ABU360080	BRACKET, interior fuse box to dash	1	1997 on.
37	ASU360080	BRACKET, bonnet release cable to shelf	1	1992-96.
38	ASU360100	BRACKET, bonnet release cable to shelf	1	1997 on; includes relay mounting.

Either of these bonnet cable brackets may of course be fitted to earlier Minis to allow easy conversion from the external bonnet release system to the altogether more secure and tamper-proof internal cable operated system. In fact, why not contact Somerford Mini for the cable and latch assembly to complete the conversion?

## Wiring Tags and Service Clips

CW100110 and CW100120, the plain rectangular wiring tags are the most commonly found tags on a Mini bodyshell. The shorter version, CW100110, is the type found on the front panel (securing the front light and horn cables) and on the floor pan. The longer version, CW100120, is usually to be seen in areas of the car where the tag has to come through a layer of insulation, carpet or both - for example on both sides of the dash panel.

39	CW100110	WIRING TAG, short	A/R	
40	CW100120	WIRING TAG, long	A/R	
41	ALA5558	SERVICE CLIP, toeboard	2	Included in toeboard assembly.